



INTERIOR
USE ONLY



FLOOR
STANDING



FAN SPEED
SETTINGS



THERMAL
PROTECTION



INGRESS
PROTECTION



USER MANUAL/INSTRUCTIONS

Please read this user's manual carefully
to ensure proper use, maintenance and installation of this product.

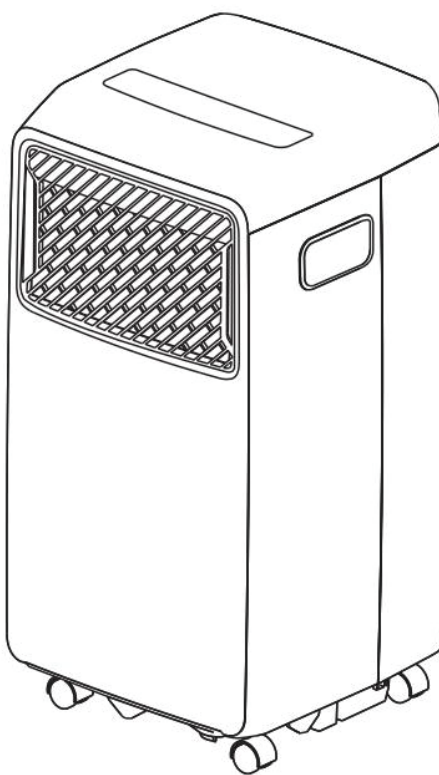

Cooling



Dehumidification



Fan

MODEL NO.: ACPO9P
ACPO9W (Wi-Fi)



CED
ELECTRICAL
GROUP

44 - 48 FRESHWATER ROAD, DAGENHAM, ESSEX, RM8 1RX (UK)
t . 020 8503 8500 | f . 020 8503 8900
www.cedelectrical.co.uk | info@cedelectrical.co.uk

Table of Contents

Safety Precautions

Safety Precautions.....	03
-------------------------	----

Installation Instructions

Preparation	08
Design Notice.	08
Ambient Temperature Range For Unit Operating.	08
Exhaust Hose Installation.....	09
Choosing The Right Location.	09
Energy Rating Information.....	09
Tools Needed.....	10
Accessories.....	10
Installation.	11

Operating Instructions

Control Panel Features.....	12
Operation Instructions.....	13
Other features.....	13

Maintenance

Safety Precautions.	15
Air Filter Cleaning.....	15
Unit Cleaning	15
Store the unit when not in use.....	15

Troubleshooting Tips

Troubleshooting Tips	16
----------------------------	----

Safety Precautions

Read Safety Precautions Before Operation and Installation

To prevent death or injury to the user or other people and property damage, the following instructions must be followed. Incorrect operation due to ignoring of instructions may cause death, harm or damage.



WARNING

This symbol indicates the possibility of personnel injury or loss of life.



CAUTION

This symbol indicates the possibility of property damage or serious



WARNING

- Installation must be performed according to the installation instructions. Improper installation can cause water leakage, electrical shock, or fire.
 - Use only the included accessories and parts, and specified tools for the installation. Using non-standard parts can cause water leakage, electrical shock, fire, and injury or property damage. Make sure that the outlet you are using is grounded and has the appropriate voltage.
- The power cord is equipped with a three-prong grounding plug to protect against shock. Voltage information can be found on the nameplate of the unit.
- Your unit must be used in a properly grounded wall receptacle. If the wall receptacle you intend to use is not adequately grounded or protected by a time delay fuse or circuit breaker (the fuse or circuit breaker needed is determined by the maximum current of the unit. The maximum current is indicated on the nameplate located on unit), have a qualified electrician install the proper receptacle.
 - Install the unit on a flat, sturdy surface. Failure to do so could result in damage or excessive noise and vibration.
 - The unit must be kept free from obstruction to ensure proper function and to mitigate safety hazards.
 - Do not modify the length of the power cord or use an extension cord to power the unit. Do not share a single outlet with other electrical appliances. Improper power supply can cause fire or electrical shock.
 - Do not install your air conditioner in a wet room such as a bathroom or laundry room. Too much exposure to water can cause electrical components to short circuit.
 - Do not install the unit in a location that may be exposed to combustible gas, as this could cause fire.
 - The unit has wheels to facilitate moving. Make sure not to use the wheels on thick carpet or to roll over objects, as these could cause tipping.
 - Do not operate a unit that it has been dropped or damaged.
 - The appliance with electric heater shall have at least 1 meter space to the combustible materials.

- Do not touch the unit with wet or damp hands or when barefoot.
- If the air conditioner is knocked over during use, turn off the unit and unplug it from the main power supply immediately. Visually inspect the unit to ensure there is no damage. If you suspect the unit has been damaged, contact a technician or customer service for assistance.
- In a thunderstorm, the power must be cut off to avoid damage to the machine due to lightning. Your air conditioner should be used in such a way that it is protected from moisture.
e.g. condensation, splashed water, etc. Do not place or store your air conditioner where it can fall or be pulled into water or any other liquid. Unplug immediately if it occurs.
- All wiring must be performed strictly in accordance with the wiring diagram located inside of the unit.
- The unit's circuit board(PCB) is designed with a fuse to provide overcurrent protection. The specifications of the fuse are printed on the circuit board, such as: T 3.15A/250V, etc.
- When the water drainage function is not in use, ensure the drain plugs are fully inserted.



CAUTION

- This appliance is not intended for use by persons (including children) with reduced physical, sensory or mental capabilities or lack of experience and knowledge, unless they have been given supervision or instruction concerning use of the appliance by a person responsible for their safety. Children must be always supervised around the unit.
- If the supply cord is damaged, it should be safely replaced by the manufacturer, a service agent or suitably qualified persons in order to avoid a hazard.
- Prior to cleaning or other maintenance, the appliance must be disconnected from the mains supply. Do not remove any fixed covers.
- Do not run cord under carpeting. Do not cover cord with throw rugs, runners, or similar coverings. Do not route cord under furniture or appliances. Arrange cord away from traffic area and where it will not be a trip hazard.
- Do not operate unit with a damaged cord, plug, power fuse or circuit breaker. Discard unit or return to an authorized service facility for examination and/or repair.
- To reduce the risk of fire or electric shock, do not use this appliance with any solid-state speed control device.
- The appliance shall be installed in accordance with national wiring regulations. Contact the authorised service technician for repair or maintenance of this unit. Contact the authorised installer for installation of this unit.
- Do not cover or obstruct the inlet or outlet grilles.

- Do not use this product for functions other than those described in this instruction manual. Before cleaning, turn off the power and unplug the unit.
- Disconnect the power from the unit if strange sounds, smells, or smoke.
- Do not press the buttons on the control panel with anything other than your fingers.
- Do not remove any fixed covers.
- Never use this appliance if it is not working properly, or if it has been dropped or damaged.
- Do not operate or stop the unit by inserting or pulling out the power cord plug.
- Do not use hazardous chemicals to clean or come into contact with the unit. Do not use the unit in the presence of inflammable substances or vapour such as alcohol, insecticides, petrol, etc.
- Always transport your air conditioner in a vertical position and stand on a stable, level surface during use.
- Always contact a qualified person to carry out repairs.
- Hold the plug by the head of the power plug when removing from a socket.
- Turn off the product when not in use.
- How to fix the appliance to its support, please refer to the installation instructions.
- Plug directly into a wall socket. It isn't recommended to use with any form of extension lead.

Disposal

When using this appliance in European countries, the following information must be followed:

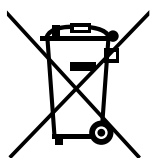

DISPOSAL:

It is prohibited to dispose of this appliance in domestic household waste. For disposal, there are several possibilities:

- Take to the nearest waste recycling or civic amenity center.
- When buying a new product, you can arrange for the retailer to take back the old product.
- The manufacture will take back the old appliance for disposal at least free of charge to the user.
- Contact your local authority to arrange for collection for which there may be a



WARNING for Using R290 Refrigerant

- Do not use means to accelerate the defrosting process or to clean.
- The appliance should be stored in a room without continuously operating ignition sources (for example: open flames, an operating gas appliance or an operating electric heater).
- Do not pierce or burn.
- Be aware that the refrigerants may be odorless.
- Compliance with national gas regulations shall be observed. Keep ventilation openings clear of obstruction.
- The appliance shall be stored to prevent mechanical damage from occurring.
- The appliance shall be stored in a well-ventilated area where the room size corresponds to the room area as specified for operation.
- Servicing shall only be performed by persons competent and qualified in the use of flammable refrigerants.
- Please follow the instruction carefully to handle/install, clear, service the air conditioner to avoid any damage or hazard. Flammable Refrigerant is used within air conditioner. When maintaining or disposing of the air conditioner, the refrigerant shall be recovered properly, so that it shall not discharge into the air directly.
- No open fire or switch device which may generate spark/arcing shall be used near the air conditioner to prevent ignition of the flammable refrigerant used.
- Flammable refrigerant is used in this air conditioner. Please follow the instruction carefully to avoid any hazard. For specific information on the type of gas and the amount, please refer to the rating label on the unit itself.
- The appliance shall be stored in a room without continuously operating open flames (for example an operating gas appliance) and potential ignition sources (for example an operating electric heater).



Caution: Risk of
fire/ flammable
materials
(Required for R290 units only)

Explanation of symbols displayed on the unit with R290 Refrigerant only:

	WARNING	Flammable refrigerant. Risk of fire if the refrigerant is leaked and exposed to an external ignition source.
	CAUTION	This operating manual should be read carefully.
	CAUTION	Only service personnel should handle this equipment with reference to the installation manual.
	CAUTION	This symbol shows that information is available such as the operating manual and installation manual.

1. Transport of equipment containing flammable refrigerants See transport regulations
2. Marking of equipment
See local regulations
3. Disposal of equipment using flammable refrigerants See national regulations.
4. Storage of equipment/appliances
The storage of equipment should be in accordance with the manufacturer's instructions.
5. Storage of packed (unsold) equipment
Storage package protection should be constructed such that mechanical damage to the equipment inside the package will not cause a leak of the refrigerant.

Installation Instructions

Preparation

NOTE:

All the illustrations in the manual are for explanation purpose only. Your machine may be slightly different. The actual shape shall prevail. The unit can be controlled by the unit control panel alone or with the remote controller. This manual does not include Remote Controller Operations, see the <<Remote Controller Instruction>> packed with the unit for details.

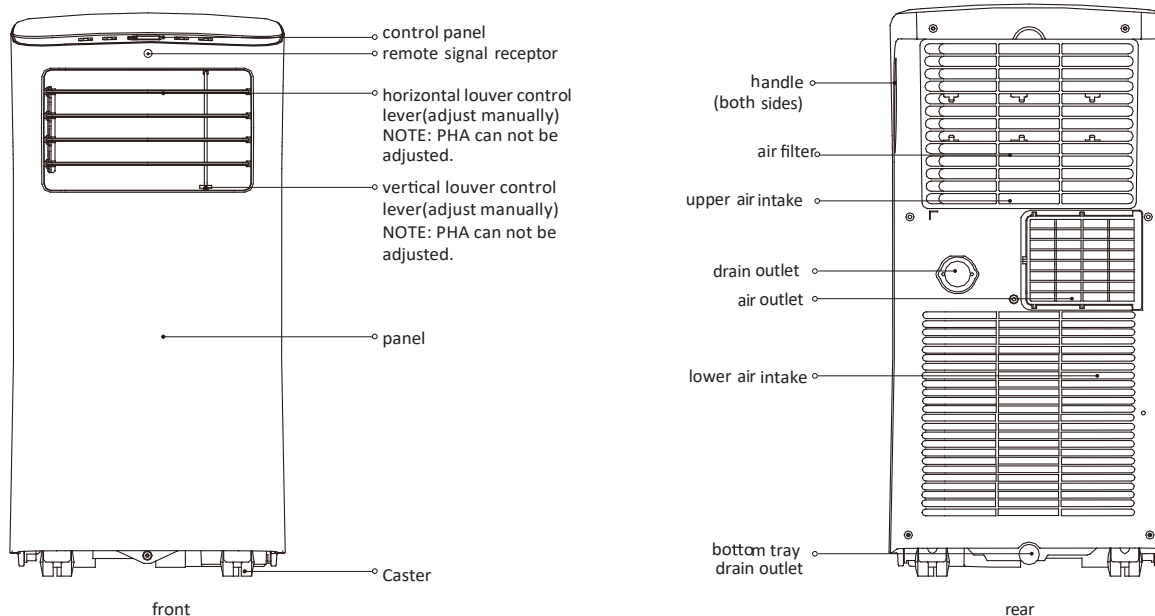

Design Notice

In order to ensure the optimal performance of our products, the design specifications of the unit and remote control are subject to change without prior notice.

Ambient Temperature Range For Unit Operating

MODE	Temperature Range
Cool	17-35°C
Dry	13-35°C

Exhaust Hose Installation

The exhaust hose and adaptor must be installed or removed in accordance with the usage mode. For COOL mode must be installed exhaust hose. For FAN, DRY mode must be removed exhaust hose.

Choosing The Right Location

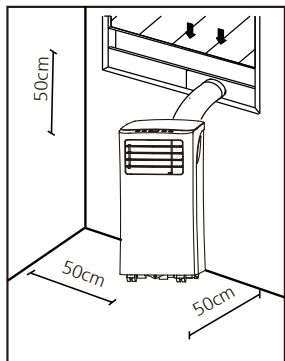

Your installation location should meet the following requirements:

- Make sure that you install your unit on an even surface to minimize noise and vibration.
- The unit must be installed near a grounded plug, and the Collection Tray Drain (found on the back of the unit) must be accessible.
- The unit should be located at least 30cm from the nearest wall to ensure proper air conditioning. The horizontal louver blade should be at least 50cm away from obstacles.
- DO NOT cover the Intakes, Outlets or Remote Signal Receptor of the unit, as this could cause damage to the unit.

Recommend Installation

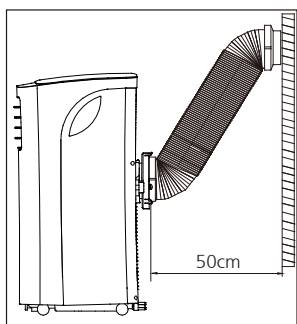

Energy Rating Information







The energy rating and noise information for this unit is based on the standard installation using an un-extended exhaust duct (as shown in the Installation section of this manual). At the same time, the unit must operate in the COOL MODE and HIGH FAN SPEED.

Tools Needed

-Medium Philips screwdriver; -Tape measure or ruler; -Knife or scissors;

Accessories

NOTE: Items with (*) are on some models. Slight variations in design may occur.

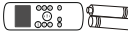
Shape	Name of Accessories	Qty.	Shape	Name of Accessories	Qty.
	Unit Adaptor	1 pc		Wall Exhaust Adaptor A (only for wall installation models)	1 pc(*)
	Exhaust Hose	1 pc		Wall Exhaust Adaptor B(with cap) (only for wall installation models)	1 pc(*)
	Drain Hose	1 pc		Screw and anchor (only for wall installation models)	4 set(*)
	Remote Controller and Battery	1 set			

Installation

Wall Installation

1. Cut a 125mm hole into the wall for the Wall Exhaust Adaptor B.
2. Secure the Wall Exhaust Adaptor B to the wall using the four Anchors and Screws provided in the kit.
3. Connect the Exhaust Hose Assembly (with Wall Exhaust Adaptor A) to the Wall Exhaust Adaptor B.

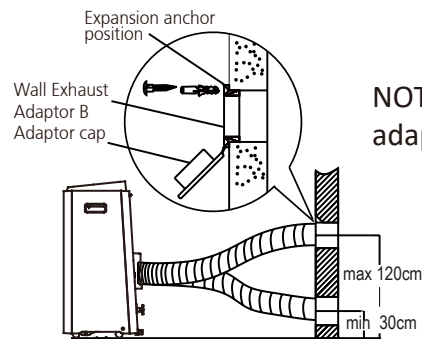

NOTE: Cover the hole using the adaptor cap when not in use.

NOTE: To ensure proper function, DO NOT overextend or bend the hose. Make sure that there is no obstacle around the air outlet of the exhaust hose (in the range of 500mm) in order to the exhaust system works properly. All the illustrations in this manual are for explanation purpose only. Your air conditioner may be slightly different. The actual shape shall prevail.



Operating Instructions

Control Panel Features

NOTE: The following control panels are for explanation purpose only. The control panel of the unit you purchased may be slightly different according to the models. Your machine may not contain some indicators or buttons.

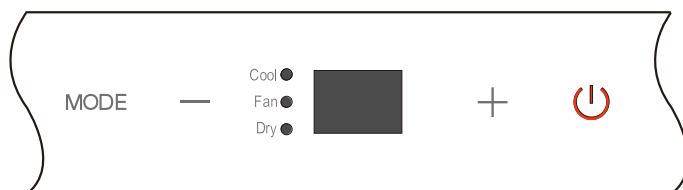

MODEL: ACPO9P

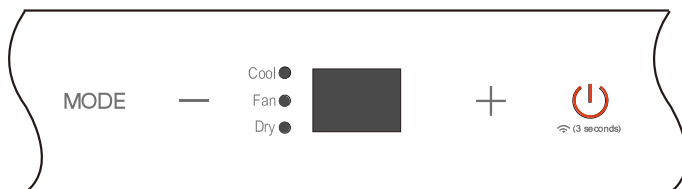

MODEL: ACPO9W

MODE

CONSTANT FAN(Press 3s)

MODE button

Selects the appropriate operating mode. Each time you press the button, a mode is selected in a sequence that goes from COOL, FAN, and DRY. The mode indicator light illuminates under the different mode setting.

NOTE: On above modes, the unit operates the auto fan speed automatically.

— +

Up (+) and Down (-) buttons

Used to adjust (increasing/decreasing) temperature settings in 1°C/2°F(or 1°F) increments in a range of 17°C/62°F to 30°C/88°F (or 86°F).

NOTE: The control is capable of displaying temperature in degrees Fahrenheit or degrees Celsius. To convert from one to the other, press and hold the Up and Down buttons at the same time for 3 seconds.



- Power indicator light
- Either Timer or Wireless indicator light
- Timer indicator light(only set by remote controller)
- Wireless indicator light(only for the unit with wireless control feature)

LED display

Shows the set temperature while on cool mode. While on DRY and FAN modes, it shows the room temperature. Shows Error codes:

E0-EEPROM error.

E1-Room temperature sensor error.

E2-Evaporator temperature sensor error.

E3-Condenser temperature sensor error (on some models).

E4-Display panel communication error.

EC-Refrigerant leakage detection malfunction(on some models).

Shows protection code:

P1-Bottom tray is full--Connect the drain hose and drain the collected water away.

NOTE: When one of the above malfunctions occurs, turn off the unit, and check for any obstructions. Restart the unit, if the malfunction is still present, turn off the unit and unplug the power cord. Contact a suitably qualified person for service.



Power button

Power switch on/off.

Operation Instructions

COOL operation

- Press the "MODE" button until the "COOL" indicator light comes on.
- Press the ADJUST buttons "+" or "-" to select your desired room temperature. The temperature can be set within a range of 17°C~30°C/62°F~88°F (or 86°F).
- Press the "FAN SPEED" button to choose the fan speed.

DRY operation

- Press the "MODE" button until the "DRY" indicator light comes on.
- The fan speed and temperature cannot be adjusted. The fan motor operates at LOW speed.

NOTE: Keep windows and doors closed for the best dehumidifying effect. Do not use the duct.

FAN operation

- Press the "MODE" button until the "FAN" indicator light comes on.
- Press the "FAN SPEED" button ON the remote controller to choose the fan speed. The temperature cannot be adjusted.
- Do not use the duct.

Wireless operation (For ACPO9W model)

When using the wireless function for the first time, press the POWER button for 3 seconds to initiate the wireless connection mode. The LED DISPLAY shows 'AP' to indicate you can set wireless connection. If connection is successful within 8 minutes, the unit will exit wireless connection mode automatically and the wireless indicator illuminates. If connection fails within 8 minutes, the unit exits wireless connection mode automatically.

After Wireless connection is successful, for some models you can press MODE and UP (+) buttons at the same time for 3 seconds to turn off Wireless function and the LED DISPLAY shows 'OFF' for 3 seconds, press MODE button and UP(+) to turn on Wireless function and the LED DISPLAY shows 'ON' for 3 seconds.

NOTE: When you restart the wireless function, it may take a period of time to connect to the network automatically.

Other features

SLEEP operation

This feature can be activated from the remote control ONLY. To activate SLEEP feature, the set temperature will increase cooling by 1°C in 30 minutes. The set temperature will then increase cooling by another 1°C after an additional 30 minutes. This new temperature will be maintained for 7 hours before it returns to the originally selected temperature. This ends the Sleep mode and the unit will continue to operate as originally programmed.

NOTE: This feature is unavailable under FAN or DRY mode.

FOLLOW ME feature

NOTE: This feature can be activated from the remote control ONLY. The remote control serves as a remote thermostat allowing for the precise temperature control at its location. To activate the Follow Me feature, point the remote control towards the unit and press the Follow Me button. The remote control will send this signal to the air conditioner until press the Follow Me button again. If the unit does not receive the Follow Me signal during any 7 minutes interval, the unit will exit the Follow Me mode.

NOTE: This feature is unavailable under FAN or DRY mode.

AUTO-RESTART

If the unit breaks off unexpectedly due to the power cut, it will restart with the previous function setting automatically when the power resumes.

AIR FLOW DIRECTION ADJUSTMENT

Adjust the air flow direction manually:

- The louver can be set to the desired position manually.
- Do not place any heavy objects or other loads on the louver, doing so will cause damage to the unit.
- Ensure the louver is fully opened under heating operation.
- Keep the louver fully opened during operation.

WAIT 3 MINUTES BEFORE RESUMING OPERATION

After the unit has stopped, it cannot be restarted operation in the first 3 minutes. This is to protect the unit. Operation will automatically start after 3 minutes.

WATER DRAINAGE

- During dehumidifying modes, remove the drain plug from the back of the unit, install the drain connector (5/8" universal female mender) with 3/4" hose (locally purchased). For the models without drain connector, just attach the drain hose to the hole. Place the open

end of the hose directly over the drain area in your room.

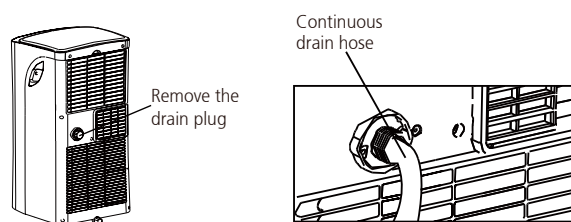

NOTE: Make sure the hose is secure so there are no leaks. Direct the hose toward the drain, making sure that there are no kinks that will stop the water flowing. Place the end of the hose into the drain and make sure the end of the hose is down to let the water flow smoothly. When the continuous drain hose is not used, ensure that the drain plug and knob are installed firmly to prevent

- When the water level of the bottom tray reaches a predetermined level, the unit beeps 8 times, the digital display area shows "P1". At this time the air conditioning/dehumidification process will immediately stop. However, the fan motor will continue to operate (this is normal). Carefully move the unit to a drain location, remove the bottom drain plug and let the water drain away. Reinstall the bottom drain plug and restart the machine until the "P1" symbol disappears.

NOTE: Be sure to reinstall the bottom drain plug firmly to prevent leakage before using the unit.

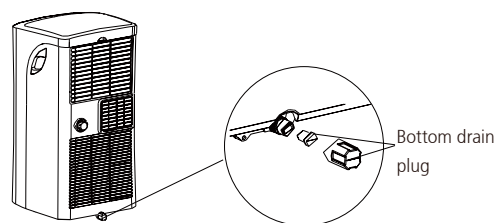

Maintenance

Safety Precautions

- Always unplug the unit before cleaning or servicing.
- DO NOT use flammable liquids or chemicals to clean the unit.
- DO NOT wash the unit under running water. Doing so causes electrical danger.
- DO NOT operate the machine if the power supply was damaged during cleaning. A damaged power cord must be replaced with a new cord from the manufacturer.

Air Filter Cleaning

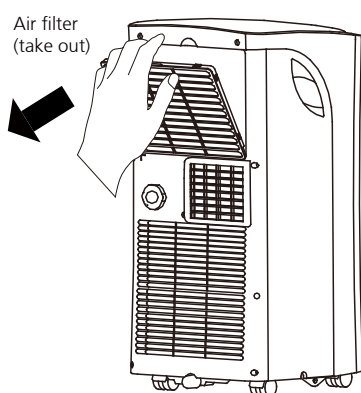

Remove the air filter



CAUTION

DO NOT operate the unit without filter because dirt and lint will clog it and reduce performance.

Maintenance Tips

- Be sure to clean the air filter every 2 weeks for optimal performance.
- The water collection tray should be drained immediately after P1 error occurs, and before storage to prevent mold.
- In households with animals, you will have to periodically wipe down the grill to prevent blocked airflow due to animal hair.

Unit Cleaning

Clean the unit using a damp, lint-free cloth and mild detergent. Dry the unit with a dry, lint-free cloth.

Store the unit when not in use

- Drain the unit's water collection tray according to the instructions in the following section.
- Run the appliance on FAN mode for 12 hours in a warm room to dry it and prevent mold.
- Turn off the appliance and unplug it.
- Clean the air filter according to the instructions in the previous section. Reinstall the clean, dry filter before storing.
- Remove the batteries from the remote control.

NOTE: Be sure to store the unit in a cool, dark place. Exposure to direct sunshine or extreme heat can shorten the lifespan of the unit.

NOTE: The cabinet and front may be dusted with an oil-free cloth or washed with a cloth dampened in a solution of warm water and mild liquid dishwashing detergent. Rinse thoroughly and wipe dry. Never use harsh cleansers, wax, or polish on the cabinet front. Be sure to wring excess water from the cloth before wiping around the controls. Excess water in or around the controls may cause damage to the unit.

Troubleshooting Tips

Problem	Possible Causes	Solution
Unit does not turn on when pressing ON/OFF button	P1 Protection Code	The Water Collection Tray is full. Turn off the unit, drain the water from the Water Collection Tray and restart the unit.
	In COOL mode: room temperature is lower than the set temperature	Reset the temperature
	E0 EEPROM error	Contact a qualified person for service.
Unit does not cool well	The air filter is blocked with dust or animal hair	Turn off the unit and clean the filter according to instructions
	Exhaust hose is not connected or is blocked	Turn off the unit, disconnect the hose, check for blockage, and reconnect the hose
	The unit is low on refrigerant	Call a service technician to inspect the unit and top off refrigerant
	Temperature setting is too high	Decrease the set temperature
	The windows and doors in the room are open	Make sure all windows and doors are closed
	The room area is too large	Double-check the cooling area
	There are heat sources inside the room	Remove the heat sources if possible
The unit is noisy and vibrates too much	The ground is not level	Place the unit on a flat, level surface
	The air filter is blocked with dust or animal hair	Turn off the unit and clean the filter according to instructions
The unit makes a gurgling sound	This sound is caused by the flow of refrigerant inside the unit	This is normal

The design and specifications are subject to change without prior notice for product improvement. Consult with the sales agency or manufacturer for details. Any updates to the manual will be uploaded to the service website, please check for the latest version.

CP001UI-PHTY

USER MANUAL OF SMART KIT



IMPORTANT NOTE:

Read the manual carefully before connecting your Smart kit(Wireless module). Make sure to save this manual for future reference. Illustrations in this manual are for explanatory purposes. The actual shape shall prevail.

CONTENTS

❶ SPECIFICATION.....	1
❷ DOWNLOAD AND INSTALL APP.....	1
❸ PREPARATION	1
❹ CREATE ACCOUNT....	4
❺ NETWORK CONFIGURATION.....	2
❻ HOW TO USE APP.....	7
❼ SPECIAL FUNCTIONS.....	9
❽ APP DECLARATION.....	14

1 SPECIFICATION

Unit model: ACPO9W

WIFI Module Model: EU-SK105, US-SK105

Antenna Type: Printed PCB Antenna

Frequency Band: 2400-2483.5MHz

Operation Temperature: 0°C~45°C/32°F~113°F

Operation Humidity: 10%~85%

Power Input: DC 5V/300mA

Maximum TX Power: <20dBm

NOTE:

Company will not be liable for any issues and problems caused by Internet, Wireless Router and Smart Devices. Please contact the original provider to get further help.

2 DOWNLOAD AND INSTALL APP

CAUTION: The following QR code is only available for downloading APP. It is totally different with the QR code packed with unit.



Android



iOS

- Android Phone users: scan Android QR code or go to google play, search 'Nethome Plus' App and download it.
- iOS users: scan iOS QR code or go to APP Store, search 'Nethome Plus' app and download it.

3 PREPARATION

- Please ensure your mobile device is connected to Wireless router. Also, the Wireless router has already connected to Internet before doing user registration and network configuration.
- Make sure your mobile device has already been connected to the Wireless network which you want to use. Also, you need to forget other irrelevant Wireless network in case it influences your configuration process.

4 CREATE ACCOUNT

Reminder: When you register to use app, you need read and agree the Data Privacy Notice.

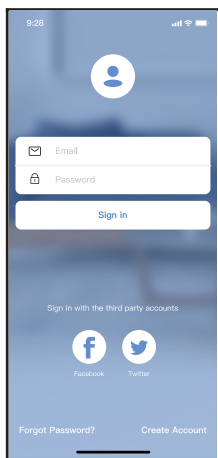

Android

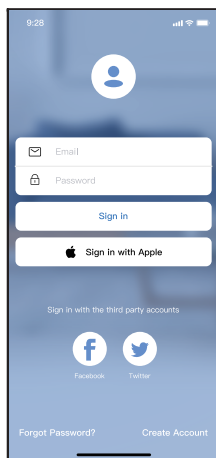

iOS

① Click “Create Account”

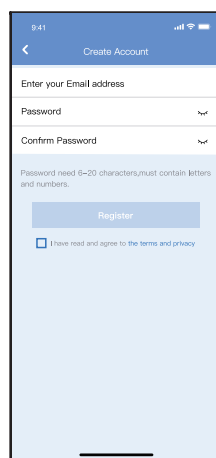

② Enter your email address and password, and then click “Register”

5 NETWORK CONFIGURATION

Cautions

- It is necessary to forget any other around network and make sure the Android or iOS device just connect to the Wi-Fi/Wireless network you want to configure.
- Make sure the Android or iOS device Wi-Fi/Wireless function works well and can be connected back to your original Wi-Fi/Wireless network automatically.

Kindly reminder:

User must finish all the steps in 8 minutes after powering on AC, otherwise you need to power on it again.

■ Using Android or iOS device to do network configuration

Make sure your mobile device has already been connected to the Wi-Fi/Wireless network which you want to use. Also, you need to forget other irrelevant Wi-Fi/Wireless network in case it influences your configuration process.

Disconnect the power supply of AC.

Connect the power supply of AC, activate the AP mode (The pictures in the manual are for explanation purpose only. Your machine may be slightly different. Read the WIRELESS MODE IN USER'S MANUAL or INSTRUCTION MANUAL for detailed operations.).

When AP appears in the display, It means that the AC WIRELESS has already entered into AP Mode. User can do the next step configuration.

Note: There are two ways to finish the network configuration:

- Network configuration by Bluetooth scan
- Network configuration by select appliance type

Network configuration by Bluetooth scan

Note: Make sure the bluetooth of your mobile device is working.

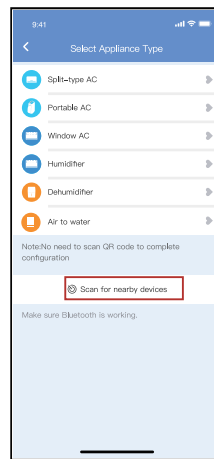
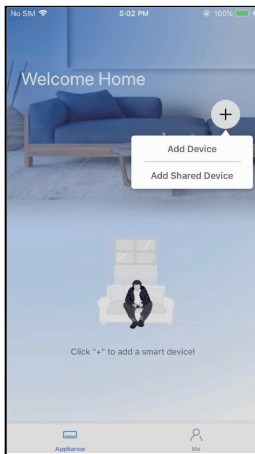
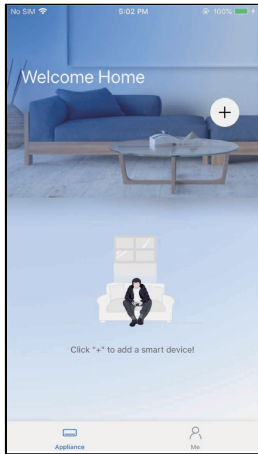

① Press “+ Add Device”

② Press “Scan for nearby devices”

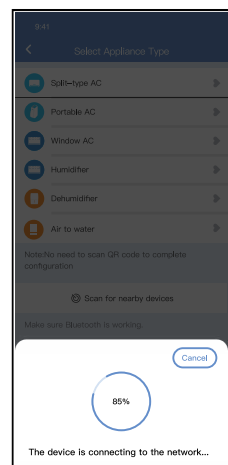
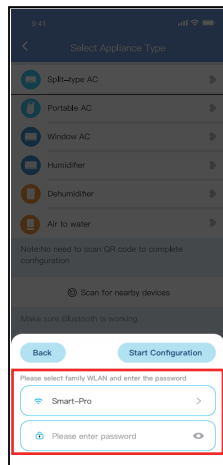
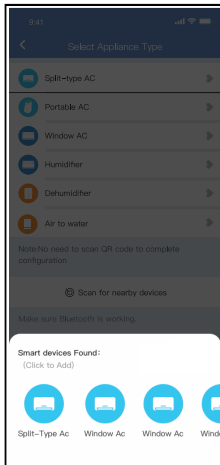

③ Wait smart devices to find, then click to add it

④ Select home wireless network, enter the password

⑤ Wait connecting to the network

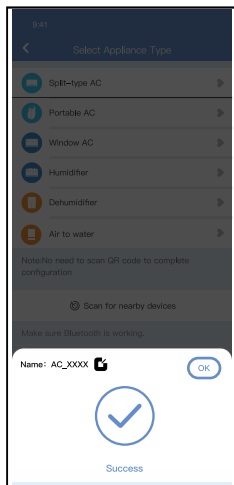

- ⑥ Configuration Success, you can see the device on the list, you can modify the default name.

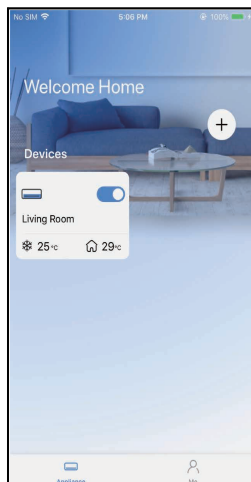
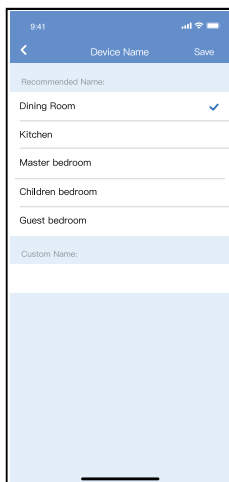

- ⑦ Bluetooth network configuration is successful, now you can see the device in the list.

Network configuration by select appliance type :

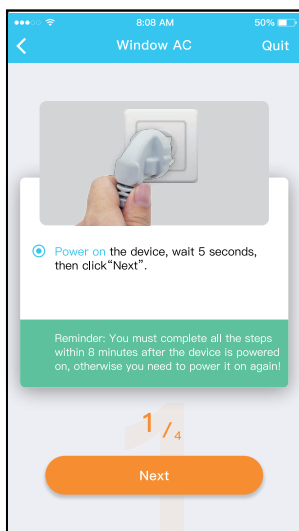
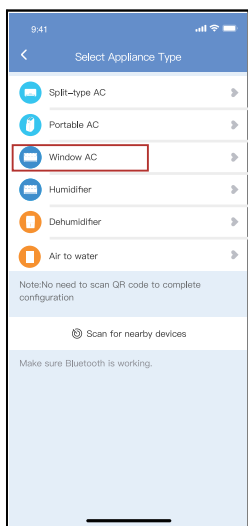

For Window AC

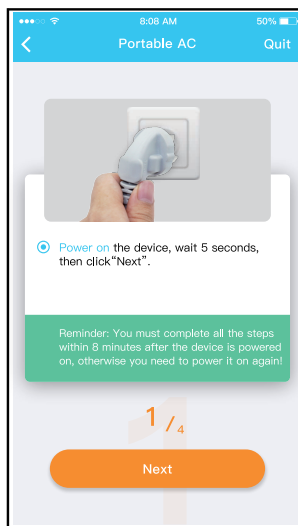

For Portable AC

- ① If the bluetooth network configuration is failure, please select the appliance type.

- ② Please follow the steps to enter "AP" mode.

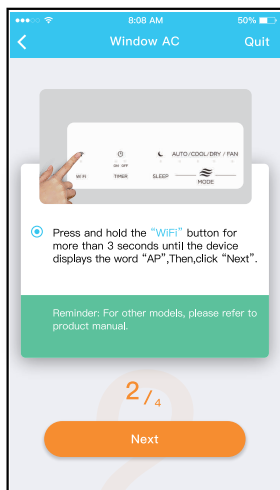

For Window AC

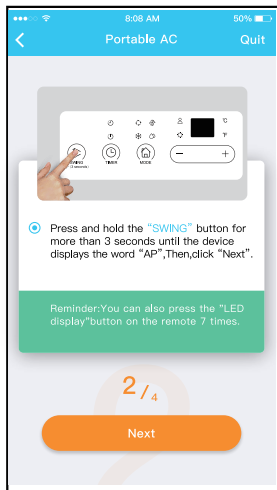

For Portable AC

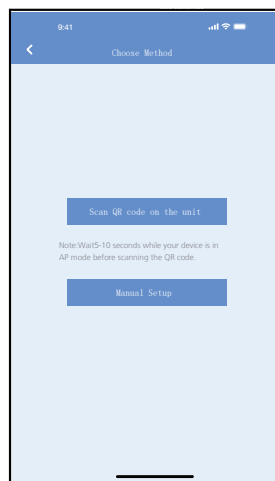

③ Choose the network configuration method.

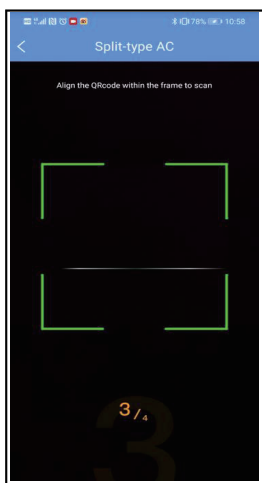

④ Choose the "Scan the QR code" method.



For Window AC

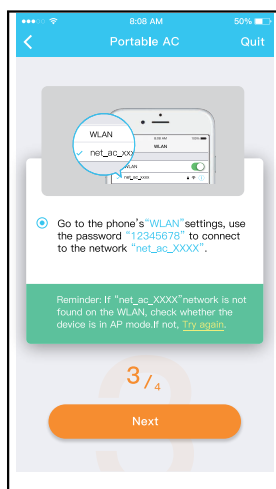

For Portable AC

⑤ When choose the "Manual Setup" method(Android). Connect to the wireless network(iOS).

NOTE: Steps ③ and ④ are applicable to Android system only. iOS system does not need these two steps.

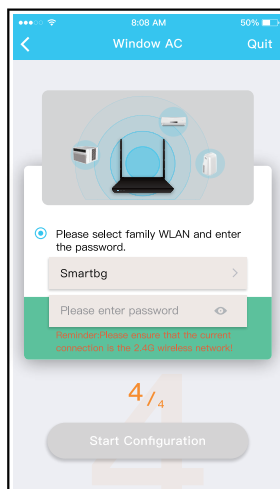

For Window AC

⑥ Please enter password

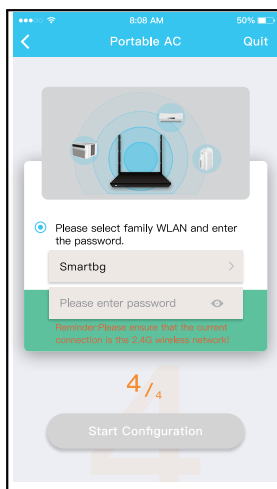

For Portable AC

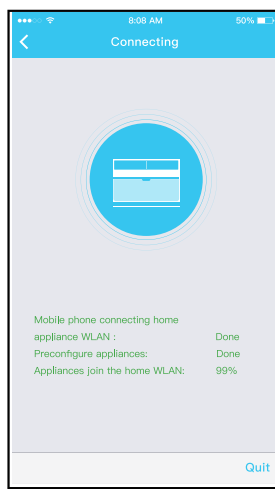

For Window AC

⑦ Network configuration is successful.

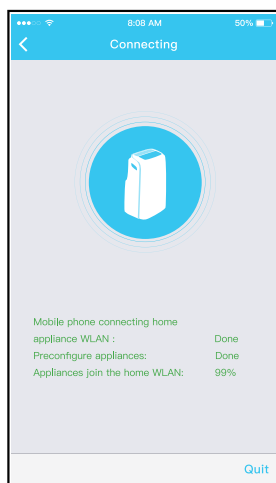

For Portable AC

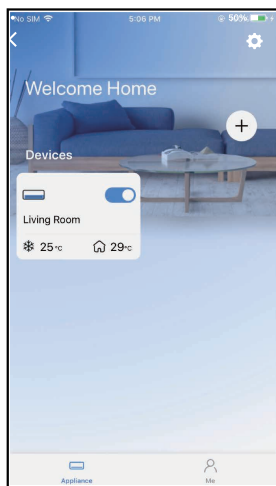

⑧ Configuration Success, you can see the device in the list.

NOTE:

- When finishing network configuration, APP will display success cue words on the screen. Due to different internet environment, it is possible that the device status still display "offline".
- If this situation occurs, it is necessary to pull and refresh the device list on the APP and make sure the device status become "online". Alternatively, user can turn off the AC power and turn on it again, the device status will become "online" after few minutes.

6 HOW TO USE APP

Please ensure both your mobile device and air conditioner are connected to the Internet before using app to control the air conditioner via internet, please follow the next steps:

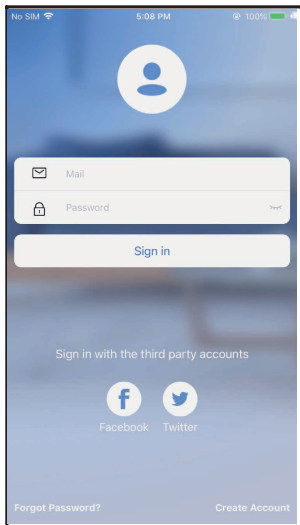

① Click “Sign in”

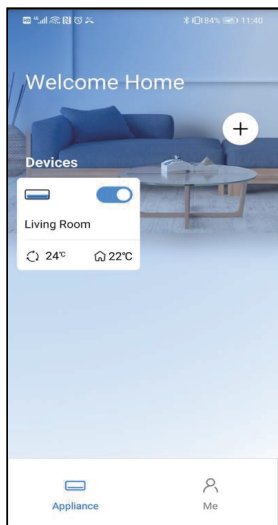

② Choose the air conditioner.

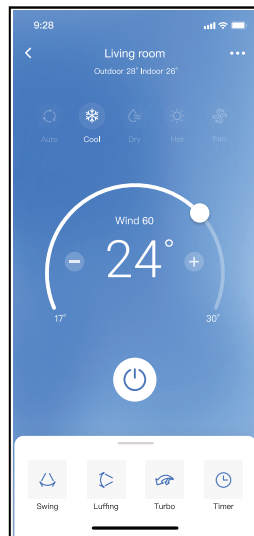

③ Thus, user can control air conditioners on/off status, operation mode, temperature, fan speed and so on.

NOTE:

Not all the function of the APP is available on air conditioner. For example: ECO, Turbo, Swing function, please check the user manual to find more information.

7 SPECIAL FUNCTIONS

■ Schedule

Weekly, user can make an appointment to turn on or off AC on specific time. User also can choose circulation to keep the AC under schedule control every week.

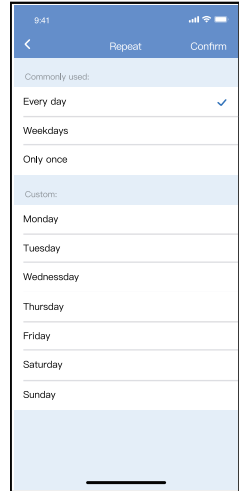
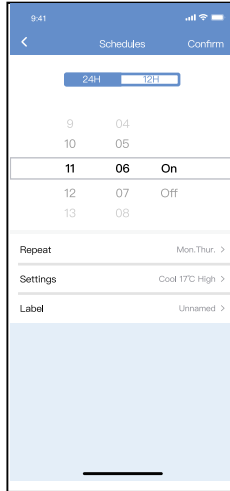
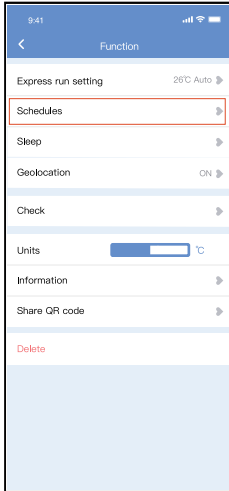

■ Sleep

User can customize their own comfortable sleep by setting target temperature.

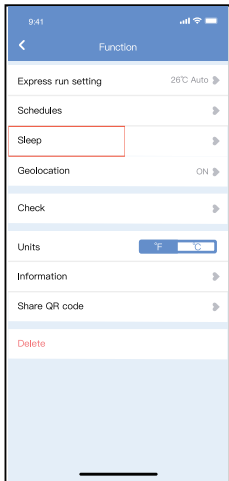

■ Check

User can simply check the AC running status with this function. When finishing this procedure, it can display the normal items, abnormal items, and detail information.

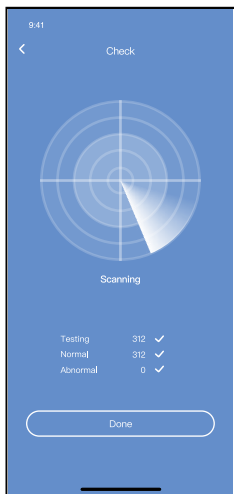

■ Share Device

The air conditioner can be controlled by multi-users at the same time by Share Device function.

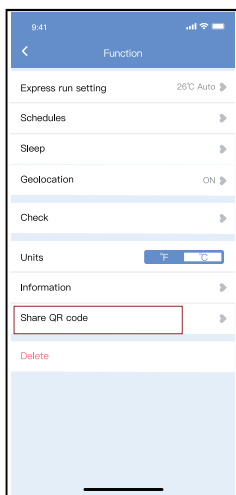

① Click “ Share QR code ”



② QR code display.

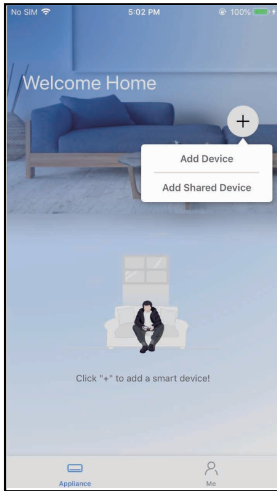

- ③ The other users must log in “Nethome Plus” app first, then click “Add Share Device” on their own mobile, then ask them to scan the QR code.

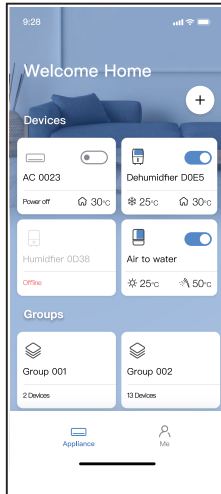

- ④ Now the others can add the shared device.

8 APP DECLARATION

- **Applicable system:IOS,Android.**

- ① APP can not support the latest software version of Android and IOS system.
- ② Due to special situation may be occurred,we explicitly claims below:Not all of the Android and IOS system are compatible with APP.We will not be responsible for any issue as a result of the incompatibility.

- **Wireless safety strategy**

Smart kit only support WPA-PSK/WPA2-PSK encryption and none encryption.
WPA-PSK/WPA2-PSK encryption is recommended.

- **Cautions**

- ① Due to different network situation,control process may return time-out sometimes. If this situation occurs,the display between board and App may not be the same,please do not feel confused.
- ② Smart Phone camera needs to be 5 million pixels or above to make sure scan QR code well.
- ③ Due to different network situation,sometimes,request time-out could happen,thus,it is necessary to do network configuration again.
- ④ The APP system is subject to update without prior notice for product function improvement. The actual network configuration process may be slightly different from the manual, the actual process shall prevail.
- ⑤ Please Check The Service Website For More Information.

Hereby, we declare that this AC is in compliance with the essential requirements and other relevant provisions of RE Directive 2014/53/EU. A copy of the full DoC is attached.

NOTE:

All the illustrations in the manual are for explanation purpose only. Your unit may be slightly different. The actual shape shall prevail.

- **Declaration of conformity**

CONTAINS FCC ID: 2ADQOMDNA21

CONTAINS IC : 12575A-MDNA21

This device complies with Part 15 of the FCC Rules and it contains licence-exempt transmitter(s)/receiver(s) that comply with Innovation, Science and Economic Development Canada's licence-exempt RSS(s).

Operation is subject to the following two conditions:

- (1) This device may not cause interference;and
- (2) This device must accept any interference,including interference that may cause undesired operation of the device.

Only operate the device in accordance with the instructions supplied. Changes or modifications to this unit not expressly approved by the party responsible for compliance could void the user's authority to operate the equipment. This device complies with FCC radiation exposure limits set forth for an uncontrolled environment. In order to avoid the possibility of exceeding the FCC radio frequency exposure limits, human proximity to the antenna shall not be less than 20cm (8 inches) during normal operation.

NOTE: This equipment has been tested and found to comply with the limits for a Class B digital device, pursuant to part 15 of the FCC Rules. These limits are designed to provide reasonable protection against harmful interference in a residential installation. This equipment generates, uses and can radiate radio frequency energy and, if not installed and used in accordance with the instructions, may cause harmful interference to radio communications. However, there is no guarantee that interference will not occur in a particular installation. If this equipment does cause harmful interference to radio or television reception, which can be determined by turning the equipment off and on, the user is encouraged to try to correct the interference by one or more of the following measures:

- Reorient or relocate the receiving antenna.
- Increase the separation between the equipment and receiver.
- Connect the equipment into an outlet on a circuit different from that to which the receiver is connected.
- Consult the dealer or an experienced radio/TV technician for help.

Company will not be liable for any issues and problems caused by Internet, Wireless Router and Smart Devices. Please contact the original provider to get further help.

Manufacturer:

GD Midea Air-Conditioning Equipment Co.,Ltd.
Lingang Road Beijiao Shunde Foshan
Guangdong People's Republic of China 528311

16120300000880
CP004IU-APWIFI(OEM)
20221014

RED Declaration Of Conformity

Product Code	ACPO9W
Product Description	Portable Air Conditioner - 9,000 BTU
Brand	Airmaster
Company Name	CED Electrical Group
Company Address	UK: 44-48 Freshwater Road, Dagenham Essex RM8 1RX. EU: CED 46 Rosemount Business Park Dublin. D11 K26W

This declaration of conformity is issued under the sole responsibility of the manufacturer. We hereby certify that the product stipulated above is in conformity with the essential requirements and other relevant requirements of the RE Directive (2014/53/EU). The product stipulated above is in conformity with the following standard and/or normative documents:

- HEALTH & SAFETY (Art. 3(1)(a)): EN 62311:2008, EN 50665:2017, EN 60335-2-40:2003 + A11:2004 + A12:2005 + A1:2006 + A2:2009 + A13:2012, EN 60335-1:2012 + A11:2014 + A13:2017 + A1:2019 + A14:2019 + A2:2019, EN 62233:2008
- EMC (Art. 3(1)(b)): EN 301 489-1 V2.2.3:2019, EN 301 489-17 V3.2.4:2020
- EN 55014-1:2017/A1:2020, EN 55014-2:2015, EN IEC 61000-3-2:2019, EN 61000-3-3:2013/A1:2019
- SPECTRUM (Art. 3(2)): EN 300 328 V2.2.2 (2019-07)

Signed For & On Behalf Of: CED Electrical Group

Date: 01.06.2023

Name:

Position:

Signature:

